



ACTUAL IMAGE

# COMMERCIAL PROJECTS

Ready to move in

- ✓ Commercial Rationale
- ✓ World Class Shopping Complex
- ✓ Studio Apartments/Guest House/Deluxe Suites
- ✓ Office Spaces

 [sales@aptpromoters.com](mailto:sales@aptpromoters.com)

 website: [www.aptp.in](http://www.aptp.in)

 8448770789, 9312212136





ACTUAL IMAGE



ACTUAL IMAGE

# SPECIFICATIONS

- 1 READY TO MOVE IN
- 2 COMPLETE SECURITY
- 3 WORLD CLASS INFRASTRUCTURE
- 4 24 HOURS POWER SUPPLY
- 5 24 HOURS WATER SUPPLY
- 6 LUXURIOUS LIFESTYLE



ACTUAL IMAGE



ACTUAL IMAGE



# Location Advantages

- 1 On NH8, RIICO Allocated Commercial Land
- 2 Approx 122 KM from Delhi & 80 KM from Gurgaon towards Jaipur.
- 3 38 plus Sanctioned Universities Nearby
- 4 Historical Town, magnificent Tourist Place
- 5 Delhi Mumbai Industrial Corridor (DMIC) shaping up.
- 6 Major Industrial Hub with 700 plus Indian and Japanese industries
- 7 Surrounded by marvellous green Aravali Hills

**NEEMRANA  
HEIGHTS**

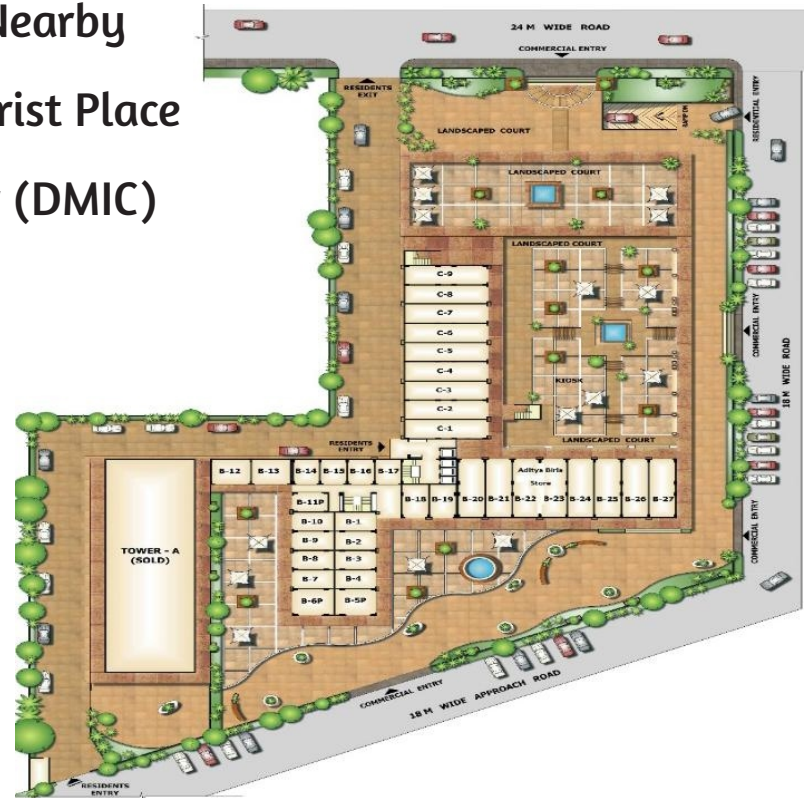

**Site Plan**



ACTUAL IMAGE



ACTUAL IMAGE

## Site Address:

Neemrana Heights

CP 3, 5 & 6, Japanese Zone, Neemrana,  
Rajasthan - 301705

## Other Projects:



### The Platinum

CP- 7 & 8, Japanese Zone,  
Neemrana,

Rajasthan - 301705



### Neemrana Pride

CC-2, Industrial Area,  
Neemrana-II,

Rajasthan - 301705

## Location Map:

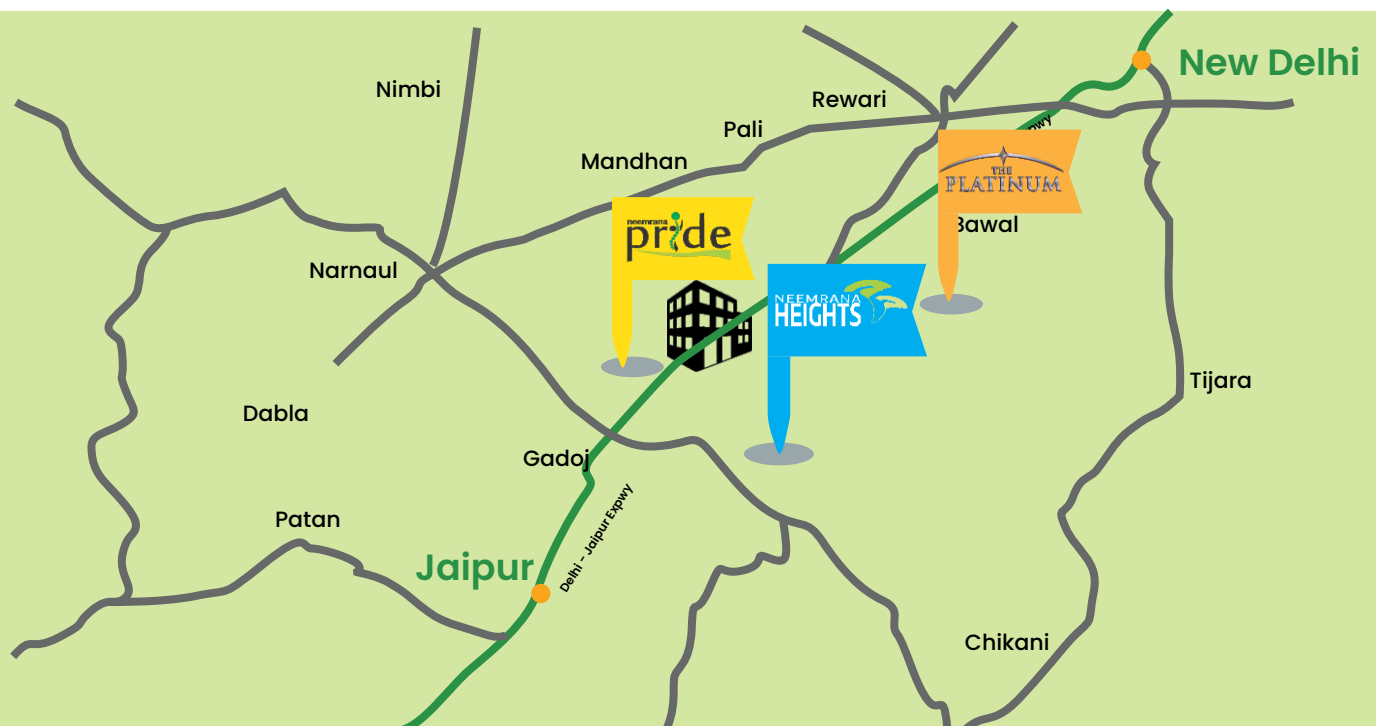

 [sales@aptpromoters.com](mailto:sales@aptpromoters.com)

 website: [www.aptp.in](http://www.aptp.in)

 8448770789, 9312212136

